



Art2528
Stainless Steel Full Bore Ball Valve (Flanged)

Operating Instructions

IMPORTANT

Before setting up or handling these ball valves, fully read this user guide and observe all the contained information. In in doubt please contact Genebre.

ATEX Technical Data

CE custody file:	LOM 11ATEX0067
ATEX Classification:	II 2 GD
Type of protection:	Constructional safety "c"
T amb. of use:	-20°C - 60°C
Thermal Class:	T6 to T3 according to the fluid inside
Max Surface Temperature (Class II):	T130°C in dust cloud -T125°C in dust thickness of 5mm.

Safety during use of this device is responsibility of the user based on the procedures laid out in this guide.

ATEX Installation

These ball valves are suitable to be set up in explosive atmospheres: Class I, Zones 1 and 2 according to IEC 60079-10, whose self-ignition temperature is 190°C, for the gas group II C, and in Class II, Zones 21 and 22 according to IEC 61241-3, whose self-ignition temperature is 130°C in combustible dust clouds, and 125°C in layers of dust with a maximum thickness of 5 mm. It is recommended to include in the maintenance program a regular cleaning of the surface of the valve to avoid thicker layers than 5mm.



Inspection, Maintenance & ATEX Repair

National regulations about maintenance, service, inspection and repair of equipment in locations with explosive atmospheres, as well as general rules of engineering, must be observed!

A defective or incomplete maintenance can bear a malfunctioning of the equipment.

A good maintenance will allow reducing the incidences of the process (costs of the “no quality”) and will guarantee, at the same time, the fulfillment of the requirements of security and specifications of the product!

It is responsibility of the user to establish a plan of inspection and maintenance of these apparatuses with the purpose of guaranteeing its safe use.

The inspections must be made only by qualified personnel, in accordance with the type of equipment and installation required.

It is possible to follow the standard UNE-EN 60079-17 as a guide, in order to carry out a plan of inspection in facilities with potentially explosive atmospheres.

Regarding to the reparation of the equipment, it is advised to follow the requirements of the standard UNE-EN 60079-19.

When the inspections are classified as “Detailed” grade, or in some cases as “Near” grade, the equipment must be totally out of service!

Use only original spare parts or recommended by Genebre

Art2528 Stainless Steel Full Bore Ball Valve (Flanged)

Features

1. Full port ball valve, 2 pieces.
2. Flanged ends according to EN 1092-1.
PN 40 DN 15 to DN 50.
PN 16 DN 65 to DN 200.
3. Made of Stainless Steel 1.4408 (CF8M).
4. Face to Face according to EN 558 series 27.
5. Ball seats PTFE + 15 % G.F.
(please ask for other materials)
6. From DN 40 with spiral wound gasket..
7. FKM (Viton) stem O' ring.
8. Blow-out proof stem.
9. Direct mounting actuator according to ISO 5211.
10. Block System included.
11. Anti-static device.
12. Fire-safe design.
13. Max. Working pressure 40 / 16 bar.
14. Working Temperature $-30\text{ }^{\circ}\text{C} + 180\text{ }^{\circ}\text{C}$.

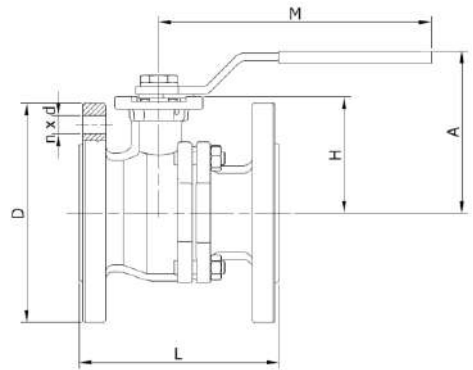
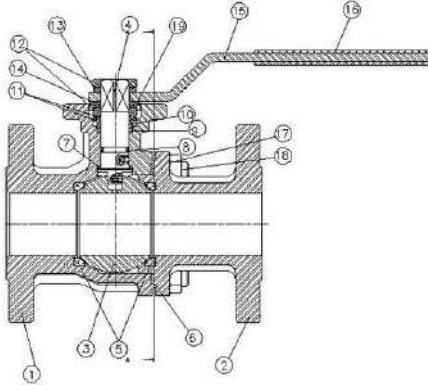

N°	Name	Material	Surface Treatment	Spare Part Code
1	Body	Stainless Steel 1.4408	Shot Blasting	
2	Cap	Stainless Steel 1.4408	Shot Blasting	
3*	Ball	Stainless Steel 1.4408	Polishing	2907
4*	Stem	Stainless Steel 316		2908
5*	Ball Seat	PTFE + 15% Graphite		2909
6*	Gasket	PTFE (Up to 1") SS + Graphite (From 1 1/4")		2909
7*	Thrust Washer	PTFE + Graphite		2909
8*	O-Ring	FKM		2909

N°	Name	Material	Surface Treatment	Spare Part Code
9*	Stem Packing	PTFE		2909
10	Gland	Stainless Steel 304		
11	Spring Washer	Stainless Steel 301		
12	Nut	Stainless Steel 304		
13	Washer	Stainless Steel 304		
14	Stopper	Stainless Steel 304		
15	Handle	Stainless Steel 304		
16	Handle Sleeve	Vinyl		
17	Nut	Stainless Steel 304		
18	Stud Bolt	Stainless Steel 304		
19	Lock Washer	Stainless Steel 304		

*Available spare parts

Sizes 2 1/2" - 8"

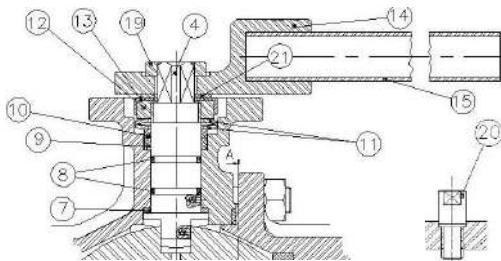

N°	Name	Material	Surface Treatment
14	Body Handle	1.4408	Shot Blasting
19	Nut	AISI 304	
20	Stopper	AISI 304	
21	Lock Washer	AISI 304	

Anti-static Device

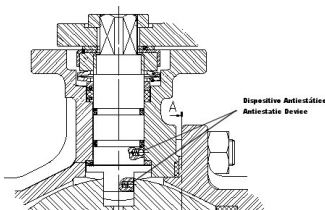

This ensures electrical continuity between the body, ball & stem, this is of special need in flammable fluids.

Stem Detail

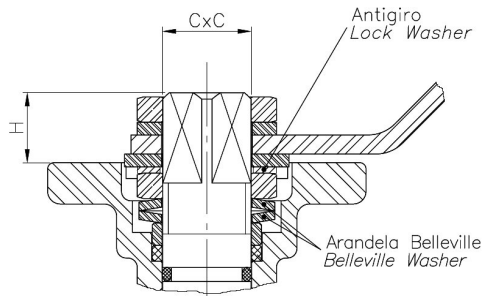

Lock Washer

Prevents unthreading of stem nut in high cycle automation applications.

Belleville Washers

Belleville washers provide constant "live load" on the stem seals, assuring a tight seal even varying service parameters.

General Dimensions

Ref	Size	PN	Dimensions (mm)									Weight (Kg)
			D	A	L	M	n x d	ISO 5211	H	h	C x C	
2528 04	1/2"	40	95	85	115	170	4 x 14	F04	46	9,5	9 x 9	2,200
2528 05	3/4"	40	105	85	120	170	4 x 14	F04/F05	51	10	9 x 9	3,050
2528 06	1"	40	116	95	125	170	4 x 14	F04/F05	57	11	11 x 11	3,750
2528 07	1 1/4"	40	140	106	130	200	4 x 18	F05/F07	71	15,5	14 x 14	5,750
2528 08	1 1/2"	40	150	110	140	200	4 x 18	F05/F07	76	15,5	14 x 14	7,000
2528 09	2"	40	165	118	150	200	4 x 18	F05/F07	83	15,5	14 x 14	9,500
2528 10	2 1/2"	16	185	170	170	380	4 x 18	F07/F10	119	21	17 x 17	14,750
2528 11	3"	16	200	170	180	380	8 x 18	F07/F10	130	21	17 x 17	18,850
2528 12	4"	16	220	170	190	380	8 x 18	F07/F10	145	21	17 x 17	26,250
2528 13	5"	16	250	200	325	520	8 x 18	F10/F12	163	34	27 x 27	38,000
2528 14	6"	16	285	220	350	620	8 x 22	F10/F12	180	34	27 x 27	51,000
2528 16	8"	16	340	334	400	800	12 x 22	F12	253	27	27 x 27	119,500

Pressure/Temperature Rating

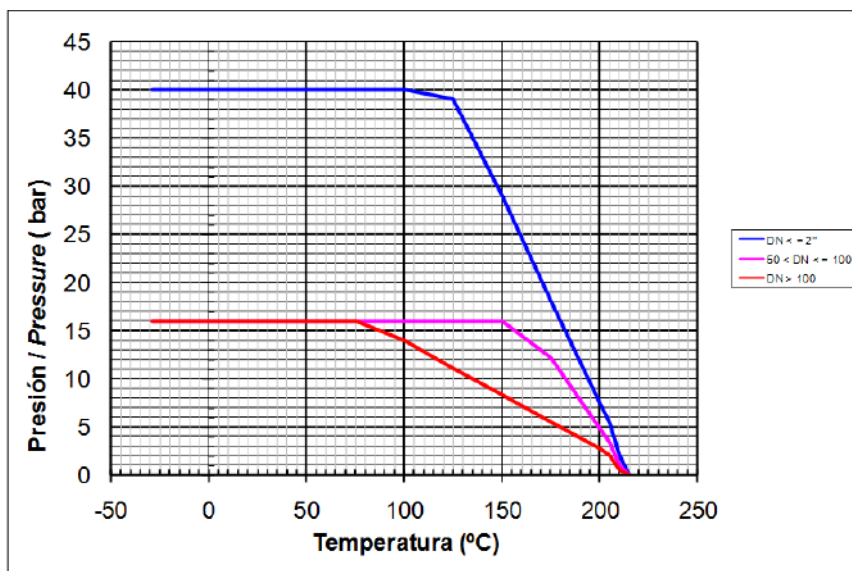



Kv Values

Kv (m3/h): Water flow rate in cubic meter per hour generating a 1 bar pressure drop across the valve.

1/2"	3/4"	1"	1 1/4"	1 1/2"	2"	2 1/2"	3"	4"	5"	6"	8"
19	40	65	110	180	365	495	970	1620	2530	4050	8650

Head Loss Chart

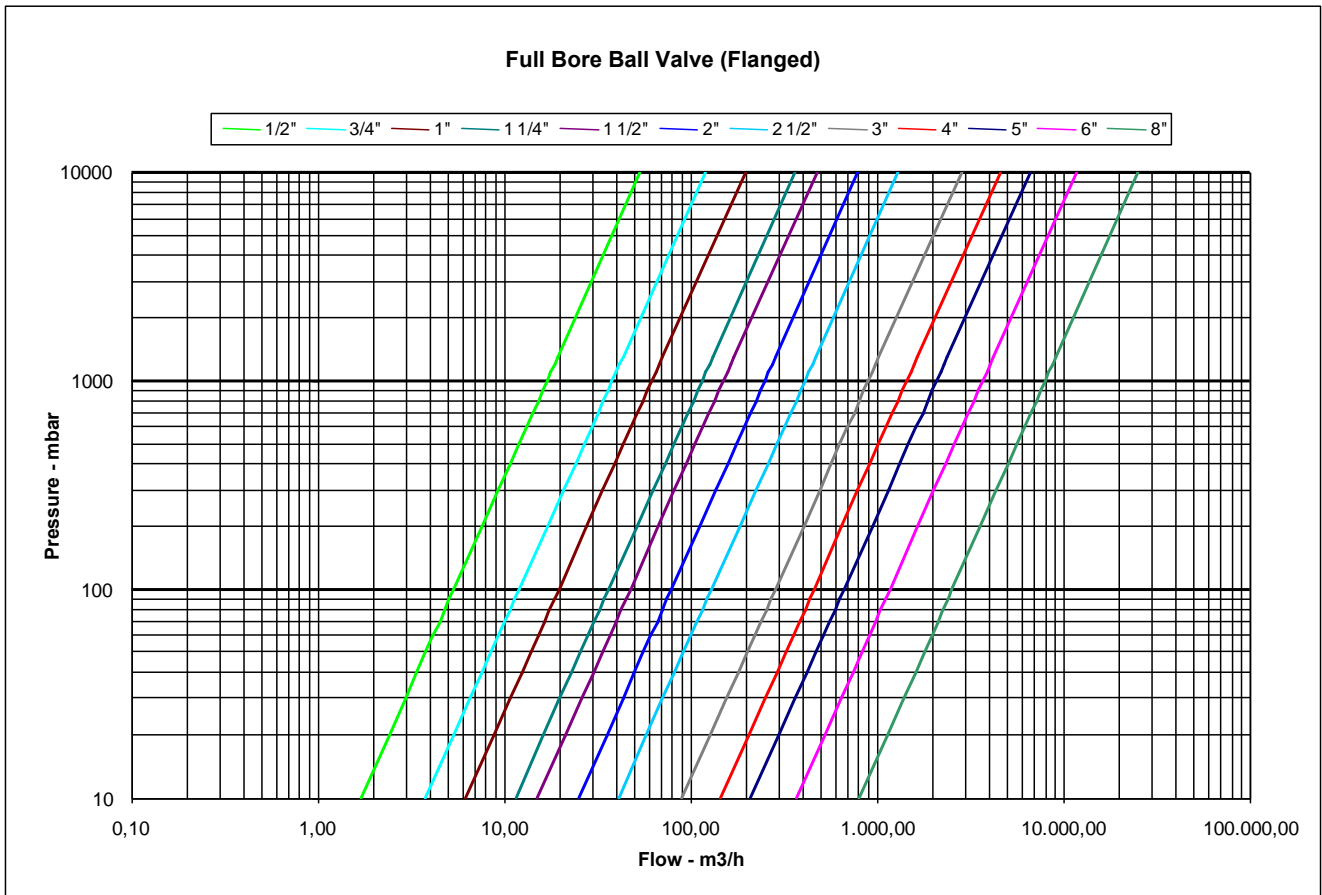



“CE” DECLARATION OF CONFORMITY

GENEBRE S.A.

Av. Juan Carlos I, 46-48 – EDIFICIO GENE BRE
08908 L’HOSPITALET DE LLOBREGAT (BCN)

DECLARES under its own responsibility that the supplied product:

Full Port Ball Valve Flanges ends Art2528

Is in accordance with the Essential Safety Requirements established in Annex II of the 2014/34/EU Directive.

For the fulfillment of the requirements, the product is according to the standards:

- UNE-EN 13463-1: 2009
- UNE-EN 13463-5: 2003

Technical Custody File: LOM 11ATEX0067

The product has been manufactured in

GENEBRE S.A.

Av. Juan Carlos I, 46-48 – EDIFICIO GENE BRE
08908 L’HOSPITALET DE LLOBREGAT (BCN)

who has the authorization to mark the product as following:

CE  II 2 GD c T6 - T3/125 °C

Date: November 10th, 2011

Sign:  A. Martinez Romay

Product Manager, Industrial Division