

LINEA

5947UAP125P30-13 RAL9002

EAN 4031582369212

Swivel castor with total lock, tail end of castor, housing made of Polyamide, precision ball bearing in swivel head, bolt hole. Wheel centre made of Polyamide, Tread: Polyurethane, precision ball bearing



BETTER MOBILITY. BETTER LIFE.



Technical Data

Wheel diameter	125 mm
Width of Tread	20 mm
Castor width	82 mm
Centre hole	13 mm
Dome-Ø	52 mm
Offset	40 mm
Swivel Interference	258 mm
Overall height	143 mm
Temperature	- 10 / + 40 °C
Standard	EN 12530
Weight	0.881 kg
Swivel Radius	129 mm
Hardness of tread	Shore A 92
Load capacity	110 kg
Load capacity (static)	220 kg

Structure & Mounting

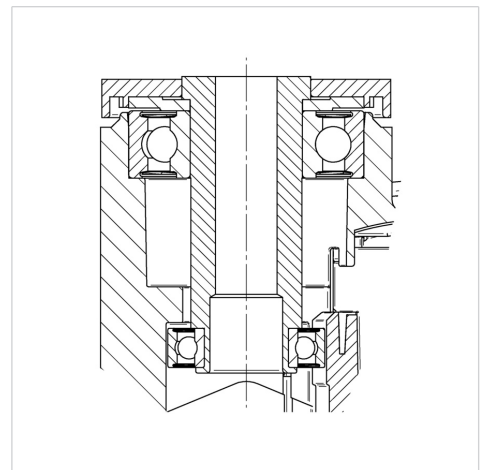

Advantages at a glance

Roll performance	● ● ● ● ●
Movement noise	● ● ● ○ ○
Attrition	● ● ● ● ○
Corrosion resistance	● ● ● ● ○