



Warranty  
**2**  
years

Indicator



J2405

J2005

J1805

- 50% less energy.
- 7 colors of LEDs possible.
- 15V to 60Vac/dc or 230Vac with galvanic isolation.
- Test led integrated.
- Relay synthesis integrated.
- Labels interchangeable.
- Terminal Plug.



Led voltage presence      Lamp test button      Button of command

### USE :

- Allows to display and grouped economically your indicators with your texts.
- For better visibility, your indicators can be reported with 7 different colors.
- button Lamp test and LED voltage presence integrated.
- A wide range of supply voltage to reduce inventory.
- Possibility of report distance information concerning only certain inputs (grouping).

### DESCRIPTION :

In front:

- LED voltage presence.
- button «TEST lamp».
- button «AUX» impulse emerged on terminal in rear to use «user».

In Rear :

- 8, 12, 24 inputs «dry contact».
- One inputs by terminal in rear external «Lamp Test».
- Terminals for wiring the back button «AUX».
- 1 relay contact General Synthesis (contacts).
- Selector for activation relay synthesis.



Our range of indicator panel, you can with one cut to install and to group 8, 12, 24 multicolored LEDs with «testlamp» integrated. On closing your contact LED high-brightness LED lights up and goes from gray to the color selected (7 choices: red, green, yellow, white, blue, cyan, magenta) and the relay report is activated if you wish.

With our technology, the LED consumes only 10mA a reduction of 50% compared to our older generation (J1800, J2000, J2400) and much less energy than filament lamp.



**WORKING :**

- The closing of contact connected to the input starts the LED corresponding. If the input was selected report, the relay synthesis will be activated.

- The opening of contact connected to the input extinguishes the LED corresponding. If the input was selected report, relay synthesis will be deactivated.

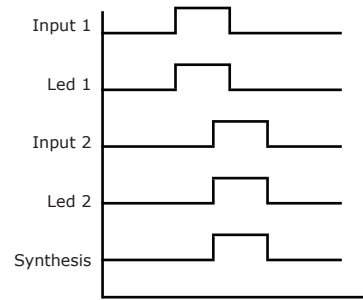
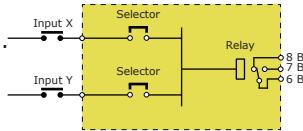

**SETTING THE COLOR OF LED :**

7 color choices can display for each input, the settings from the front by switch. Depending on the setup, you have the choice of the following colors: Green, Yellow, Red, White, Blue, Magenta, Cyan, Off. the change of LED is no longer necessary.

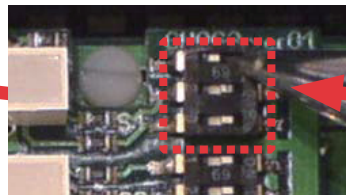
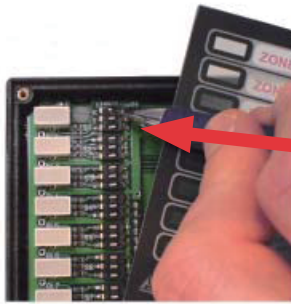

	ON	OFF
Bleu		
Blue		
Vert		
Green		
Rouge		
Red		
Jaune		
Yellow		
Magenta		
Magenta		
Cyan		
Cyan		
Blanc		
White		
Eteint		
Off		

**BUTTON «Test» & «AUX» :**

A button «Test» on the front of the panel, you can perform a «test LED» General. A terminal «EL» to the rear of the panel allows you to have a external button for a general «test led» on one or more panels. It is possible to test all LEDs and relay synthesis by pressing the button «test» or simply by activating the terminal «EL».

On the front of the panel next to the button «Test» is the push button «AUX», this push button is floating, this the contact closure is connected to terminal «BP AUX» on the rear of device and allows sending information to remote (for example : call operator).

Connecting external lamp test (EL) and the «AUX» in front

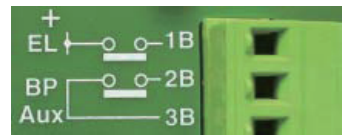

**RELAY FOR SYNTHESIS :**

The relay synthesis allows you to remotely send information indicating that at least one selected input is present. Jumpers to select the input who will activate the relay synthesis. It will remain activated as one of the input will be enabled, allowing to send selective information remotely.

- Relay Test possible or not by the function «Test led» by putting the jumper on the terminal «S». The relay terminal is located at the rear of the device, gives the 2 points of contact and common.

This relay allows you to retrieve a dry contact (exit with reverser contact ).

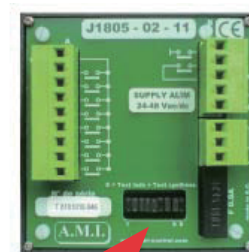

Selection jumper

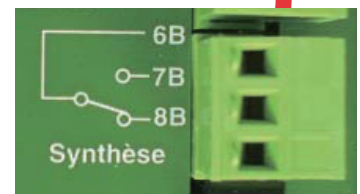

Relay output synthesis

Inputs	State of input	Selector	Synthesis relay
Input X	Off	On or Off	Off
Input X	On	Off	Off
Input X	On	On	On
Input X + Input Y	On + On	On + On	On
Input X + Input Y	On + Off	On + On	On
Input X + Input Y	Off + Off	On + On	Off

The relay is activated if a single input selected is presente

**DESIGN LABELS :**



The labels are merely pieces of paper that fit into a pouch included in the thick of the front. A blank label is provided with each unit.

They can be hand made or printed on a color printer (laser or inkjet). A PC software lets you create, include pictures, store and duplicate the achievements.

Possibility of printing on plastic sheets for printer (not included) in areas with high humidity).

## DEFINITION OF INPUT :

Polarity «+» on the input, turns on the LED.  
(the LEDs are connected to «-» in the panel).  
The «input positive» is standard.

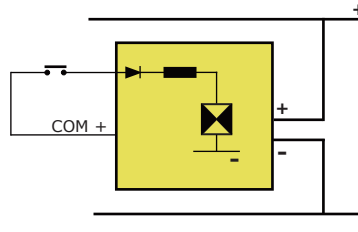

The closure of a contact on the inputs start of LED and the function relay synthesis (if selected).

## POSSIBLE CONNECTIONS :

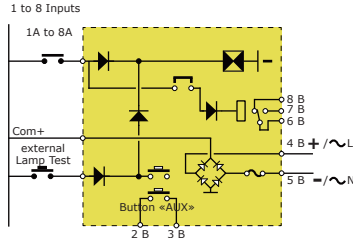

Figure 1:  
Supply with direct voltage (DC) or direct alternative voltage (AC).  
Using inputs in «dry contact».  
(contacts are powered by an internal voltage to the device on the «com» ).  
The power contacts are protected by the fuse.  
Figure for version : 15 to 60Vac/dc.

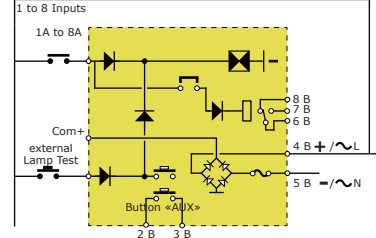

Figure 2:  
Supply with direct voltage (DC) or direct alternative voltage (AC).  
Using inputs in «dry contact».  
(contacts are powered with the same voltage as the device and with the polarity arriving on terminal 4B or 5B).  
The power contacts aren't protected.  
Figure for version : 15 to 60Vac/dc.

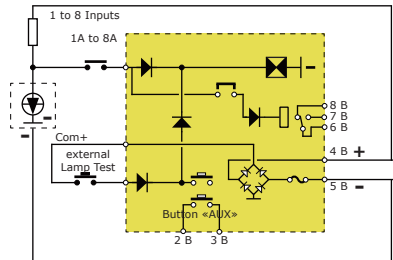

Figure 3 :  
Supply with direct current voltage (DC) with «open collector» for inputs.  
A resistance reminder to «+» is required.  
A return to power «-» is to predict.  
The power contacts are not protected.  
The LED illuminates when the «Open collector» is blocking.  
Figure for version : 15 to 60Vac/dc.

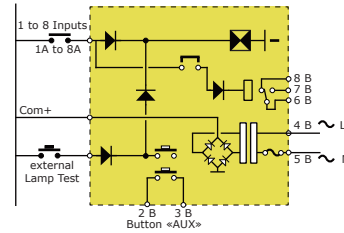
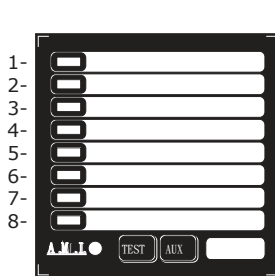

Figure 4:  
Supply with alternative current voltage (AC) with galvanic isolation.  
Using inputs in «dry contact».  
(contacts are powered by an internal voltage to the device on the «com» ).  
The power contacts are protected by the fuse.  
Figure for version : 230Vac with galvanic isolation.

## FRONT :

### Numbering of inputs



J1805

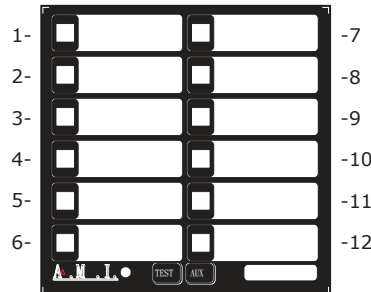

J2005

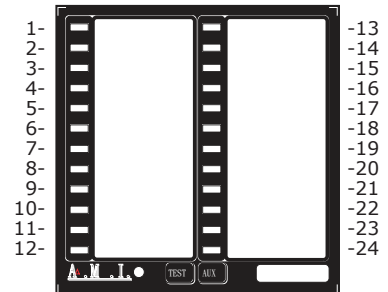

J2405

## REAR :

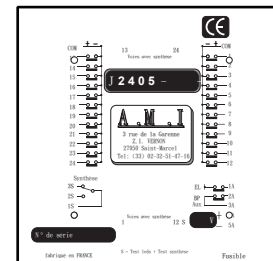
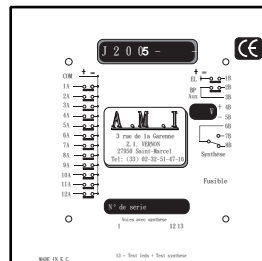
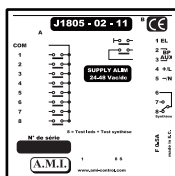

## CUTTING :

Format DIN 96x96

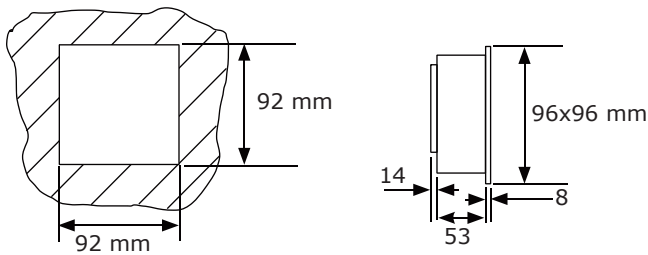

Format DIN 144x144

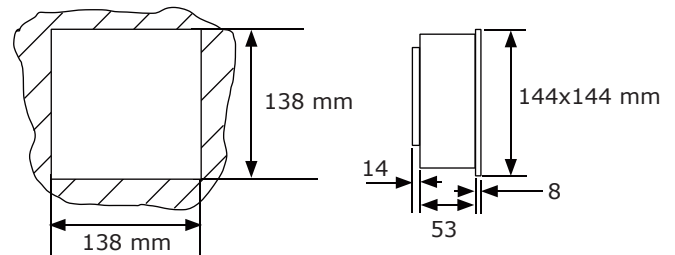

Relay synthesis : 1RT  
6A (12Vac/dc)  
0,15A (240Vac/dc)

Button «AUX» :  
6A (12Vac/dc)  
0,2A (240Vac/dc)

Temperature rated :  
-20°C / +60°C  
Storage temperature :  
-20°C / +70°C

Humidity :  
100% sans condensation  
Storage humidity :  
70%

Front / Rear protection :  
IP52 / IP22  
Protection with front cover  
optionnal :  
IP54

## SPECIFICATIONS :

	Tension on the input	Minimum total consumption	Maximum total consumption	Dimensions in mm L x l x P	Poids in g
<b>J1805</b> 15 to 60Vac/dc 230Vac*	15 to 60Vac/dc com	5mA 6mA	5mA 15mA	96x96x75 96x96x75	260g 370g
<b>J2005</b> 15 to 60Vac/dc 230Vac*	15 to 60Vac/dc com	5mA 6mA	5mA 15mA	144x144x75 144x144x75	530g 640g
<b>J2405</b> 15 à 60Vac/dc 230Vac*	15 to 60Vac/dc com	5mA 13mA	5mA 22mA	144x144x75 144x144x75	560g 750g

\* Power supply with galvanic isolation with agreement UL506, CSA 22-1, VDE, EN60950, EN61558-1, EN61558-2-6.

## REFERENCE OF ORDER :

### JXXXX-0X-11

Panel with 8 indicators **J1805**  
Panel with 12 indicators **J2005**  
Panel with 24 indicators **J2405**

1 : Relay synthesis integrated

1 : Input «Positif» / Dry Contact

02 : 15 to 60Vac/dc

05 : 230Vac with galvanic isolation.

### Exemple :

**J1805-02-11**, J1805 supplied 15 to 60Vac/dc, positive input with relay synthesys integrated.

## COMPLEMENTARY PRODUCTS :

### M0720 / M0721 / M0722 / M0723, waterproof IP54 Front

The M0720 is an IP54 waterproof cover that mounts directly in front of the product. An O-ring provides the seal between the enclosure and the panel. The front consists of a transparente door and opening.

M0720 Button closure «quarter turn» format 144x144

M0721 closing lock key format 144x144

M0722 Button closure «quarter turn» format 96x96

M0723 closing lock key format 96x96

### M0800 front 19-inch brushed aluminum Ht : 4U

For rack, pre-cut 3 holes 138x138

### M0815 Cache shutter 144x144

to be mounted to front of M0800

### M0810 front 19-inch brushed aluminum Ht : 3U

For rack, pre-cut 4 holes 92x92

### M0816 Cache shutter 96x96

to be mounted to front of M0810



**M0722**



**M0720**



**M0800 / M0815**



**M0810 / M0816**

