

Technical catalog



TABLE OF CONTENTS

SERIES 26 PUMPS

- Features 3
- General specifications and performance data 4
- Performance data charts 5
- Standard catalog assemblies - dimensions 9
- Order numbers 10
- Optional configurations 13
- Component parts - dimensions 14
- Model code - single 17
- Model code - multiple 19
- Side-load applications 22
- Load sensing priority valve 24

SERIES 26 MOTORS

- General specifications 25
- Performance data 26
- Model code - single 28

SERIES L2 PUMPS

- General specifications and performance data 30
- Performance data charts 31
- Standard catalog assemblies - dimensions 33
- Order numbers 34
- Optional configurations 36
- Component parts - dimensions 37
- Model code - single 40
- Model code - multiple 42

Series 26 pump Features

Pressures to 3500 PSI and flow to 24.1 GPM

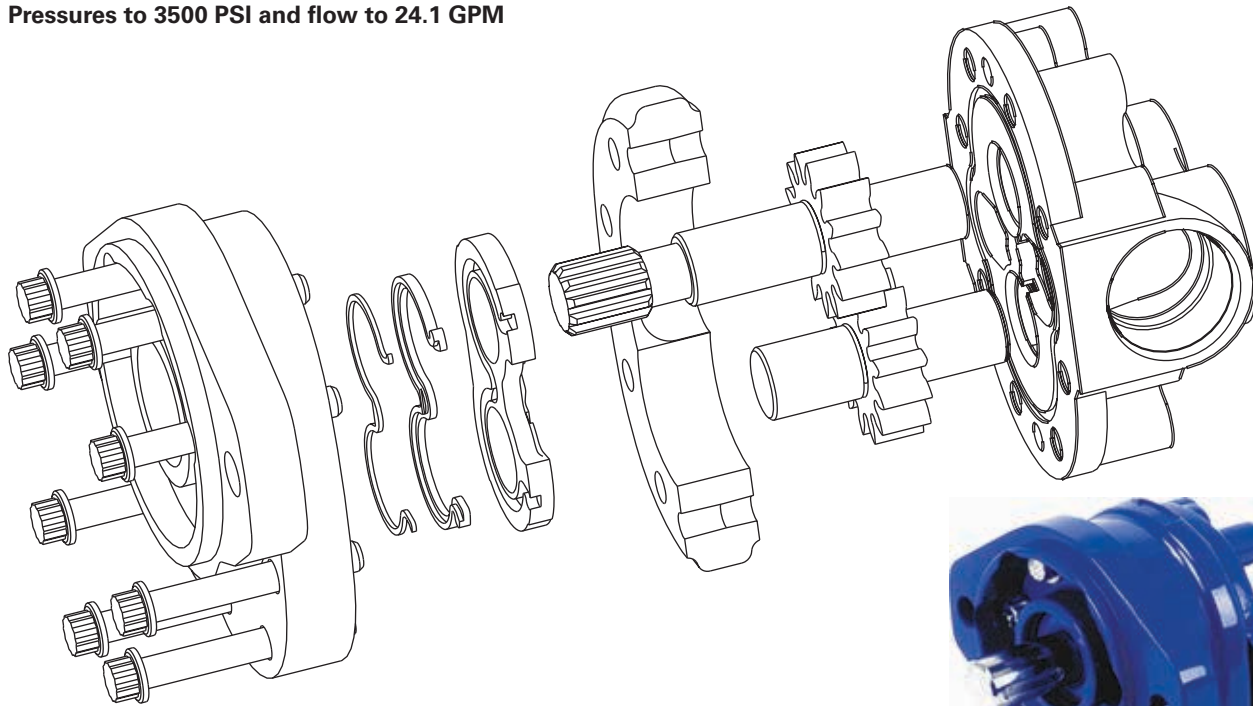

Quiet operation

- The 13-tooth gears, versus 10 teeth in previous pumps, minimizes the flow ripple. This reduces noise as well as vibration.
- The improved trap reliefs not only increase power, they also help keep oil flowing smoothly to reduce noise.

Improved efficiency

- Improved bearing lubrication system uses inlet oil instead of high pressure oil, improving volumetric efficiency for more power output.
- The highly polished shaft and gears improve mechanical efficiency and reduce wear on these components, adding to the service life and reliability of the pump.
- The optimized trapped oil relief areas help reduce pressure ripple for quieter operation. This also decreases the input power requirements.

Field reversible

- The innovative new wear plate permits simple field reversibility of the pump direction. Simply open the pump, switch the drive gear and idler gear, reposition the plug and reassemble. No extra parts are needed.

Interchangeability

- The Series 26 Gear Pump has been designed to retrofit equipment using the B1 and B2 Gear Pumps. Extra shafts, porting, and mounting configurations, as well as 13 available displacements, give you the choices you need for an easy conversion to this superior pump.

Series 26 pump

General specifications and performance data

Rotation	Field reversible
Mounting flange	SAE A 2 Bolt
Max. Continuous pressure†	210 bar [3000 PSI]*
Max. Intermittent pressure††	240 bar [3500 PSI]**
Minimum speed at continuous pressure	750 RPM
Maximum rotating torque at 0 pressure	4 Nm [36 lb-in]
Maximum continuous operating temperature	105°C [220°F]
Minimum continuous oil viscosity	5.7 cSt [45 SUS]
Minimum operating temperature	-29°C [-20°F]
Maximum inlet vacuum at operating condition	0,8 bar Abs. [11.6 psi Abs.]

† Continuous - pump may be run continuously at these ratings.

†† Intermittent - intermittent operation, 10% of every minute.

* 30.6 cm³/rev. [1.87 in³/rev.] displacement max. continuous pressure is 190 bar [2750 PSI].

** 30.6 cm³/rev. [1.87 in³/rev.] displacement max. intermittent pressure is 224 bar [3250 PSI].

For side load limits consult your Eaton representative.

Displacement cm³/r [in³/r]	6,6 [.40]	8,2 [.50]	9,5 [.58]	10,8 [.66]	13,8 [.84]	16,7 [1.02]	19,7 [1.20]
Max. Intermittent pressure bar [PSI]	241 [3500]	241 [3500]	241 [3500]	241 [3500]	241 [3500]	241 [3500]	241 [3500]
Rated speed (RPM)	3600	3600	3600	3600	3600	3600	3200
Minimum output flow at 207 bar [3000 PSI] and rated speed LPM [GPM]	20,1 [5.3]	25,0 [6.6]	29,5 [7.8]	33,7 [8.9]	43,5 [11.5]	55,3 [14.6]	57,9 [15.3]
Input power at 207 bar [3000 PSI] and rated speed and cont. Pressure kW [HP]	9,7 [13.0]	11,9 [15.9]	14,1 [18.9]	15,5 [20.8]	20,0 [26.8]	22,0 [29.4]	26,2 [35.2]

Displacement cm³/r [in³/r]	22,5 [1.37]	24,3 [1.48]	25,2 [1.54]	27,7 [1.69]	29,0 [1.77]	30,6 [1.87]
Max. Intermittent pressure bar [PSI]	241 [3500]	241 [3500]	241 [3500]	241 [3500]	234 [3400]	224 [3250]
Rated speed (RPM)	3000	3000	3000	3000	3000	3000
Minimum output flow at 207 bar [3000 PSI] and rated speed LPM [GPM]	62,1 [16.4]	67,0 [17.7]	69,7 [18.4]	76,5 [20.2]	79,9 [21.1]	84,4 [22.3]
Input power at 207 bar [3000 PSI] and rated speed and cont. Pressure kW [HP]	27,3 [36.6]	30,5 [40.9]	31,0 [41.6]	33,4 [44.8]	35,4 [47.4]	37,4 [50.1]

The performance data in the table above and the following graphs was collected using a mineral base oil with a viscosity of 133 SUS at 49°C [120°F].

Series 26 pump Performance data charts

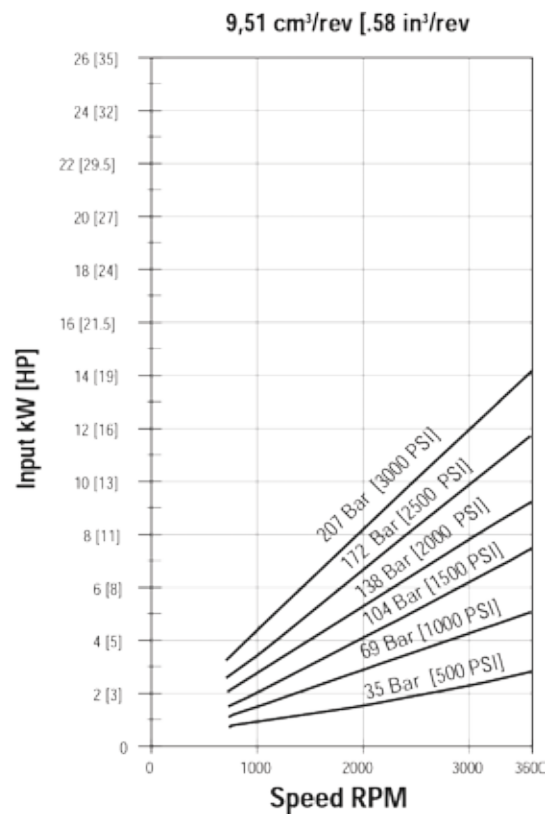
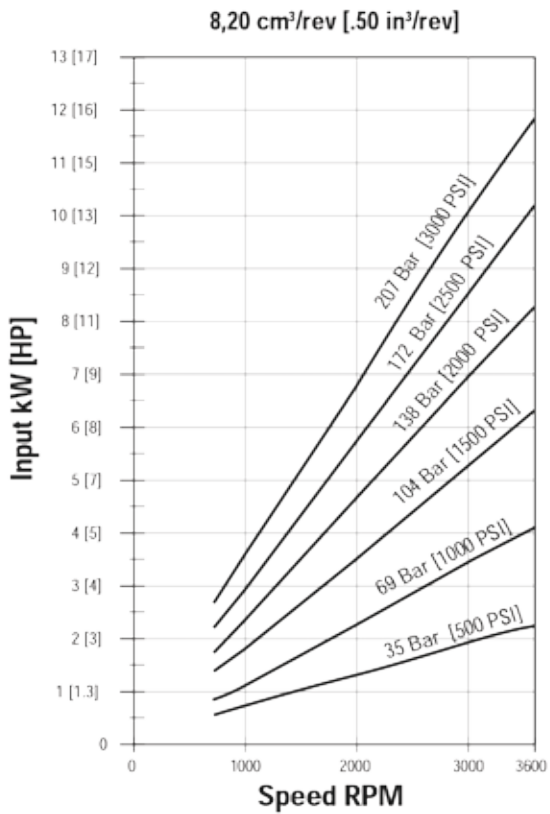
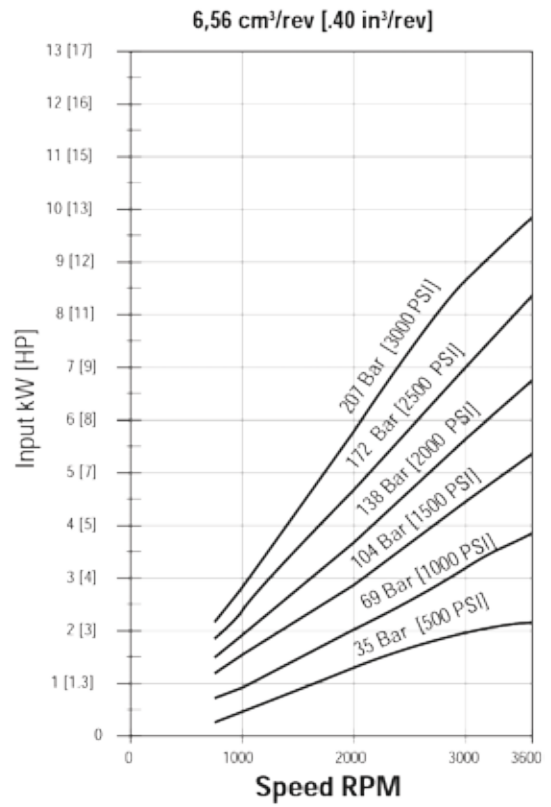
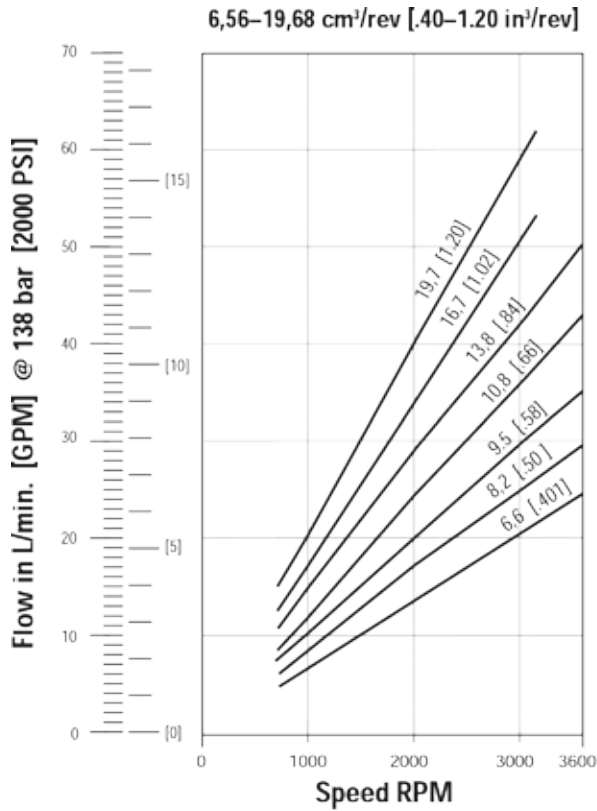

Series 26 pump Performance data charts

10,82 cm³/rev [.66 in³/rev]

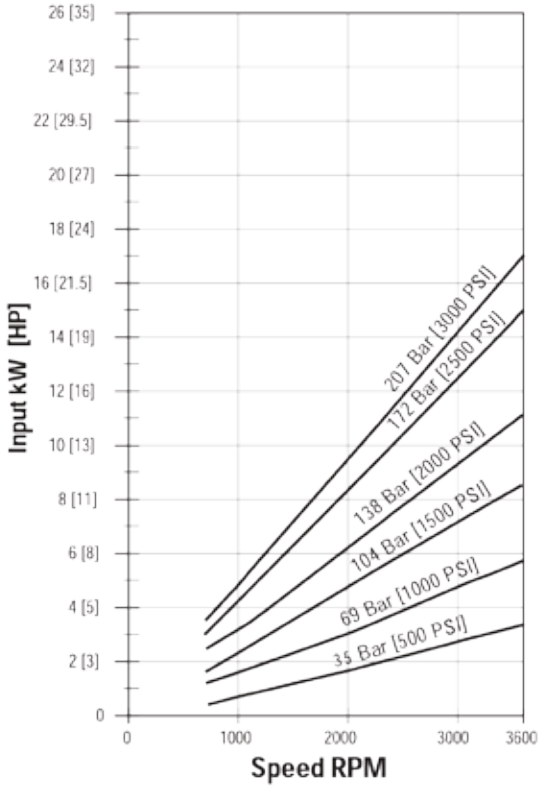

13,78 cm³/rev [.84 in³/rev]

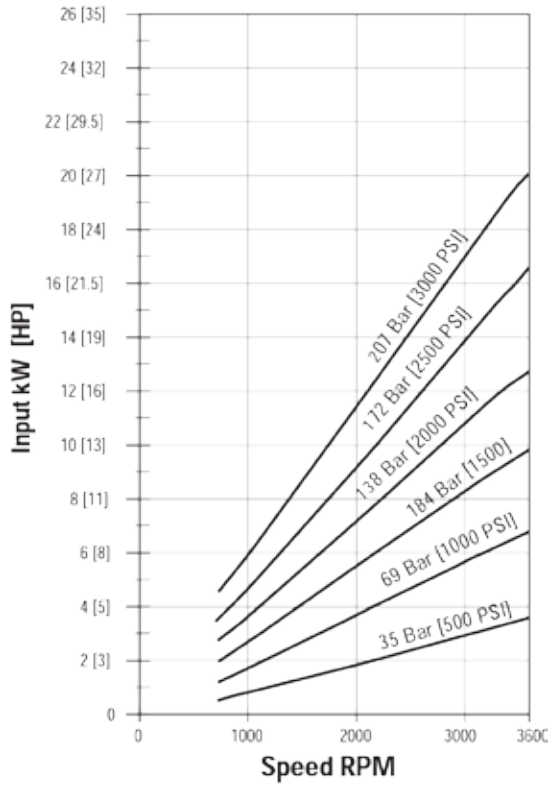

16,73 cm³/rev [1.02 in³/rev]

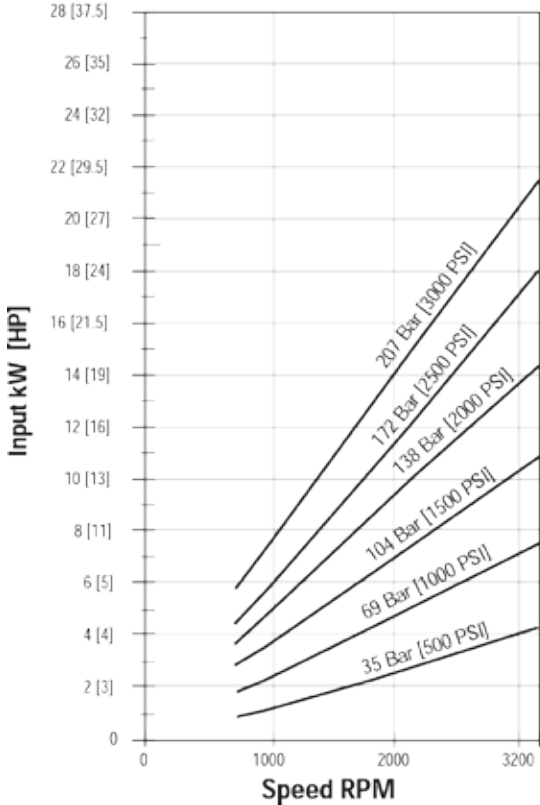

19,68 cm³/rev [1.20 in³/rev]

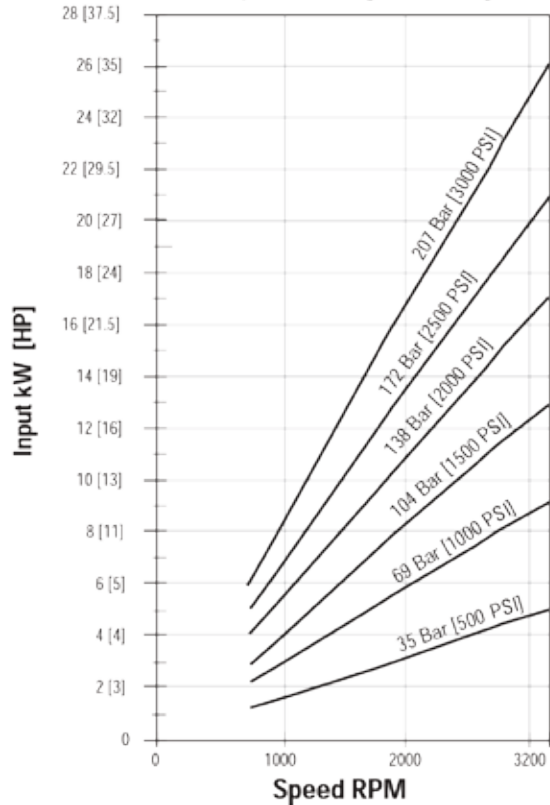

Series 26 pump Performance data charts

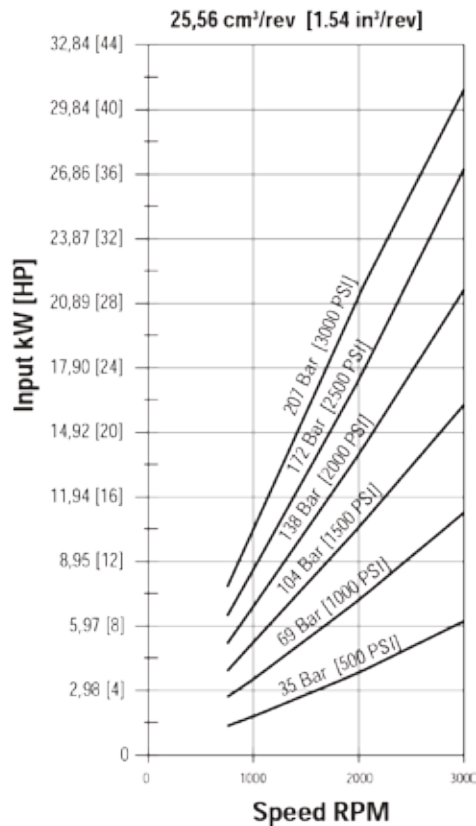
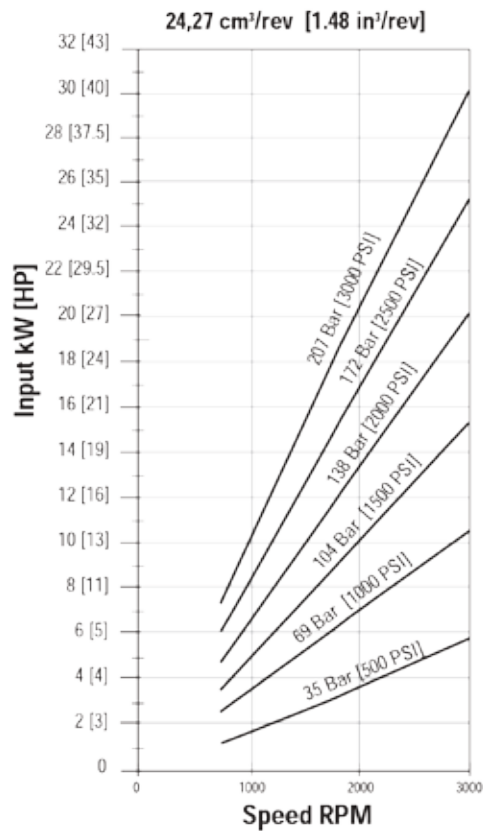
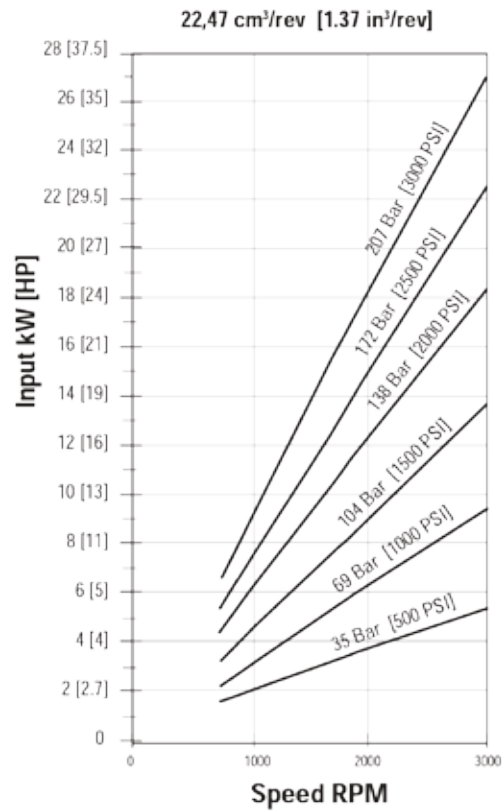
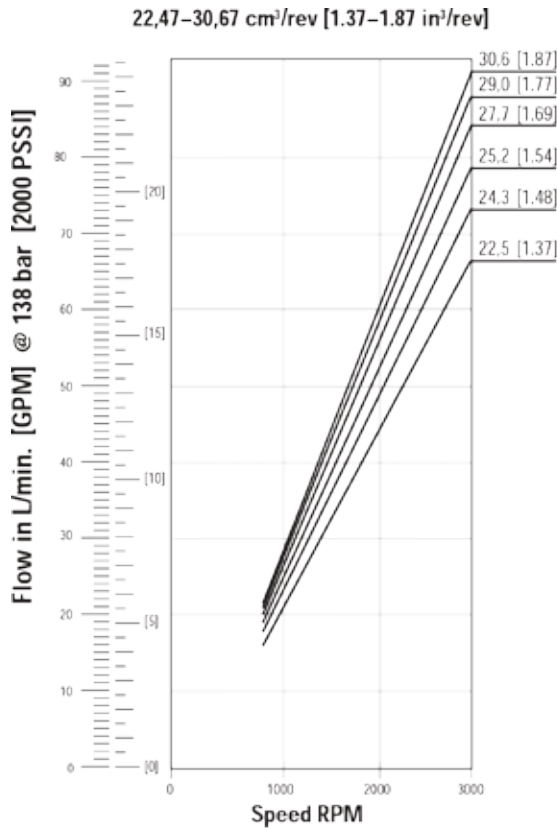

Series 26 pump Performance data charts

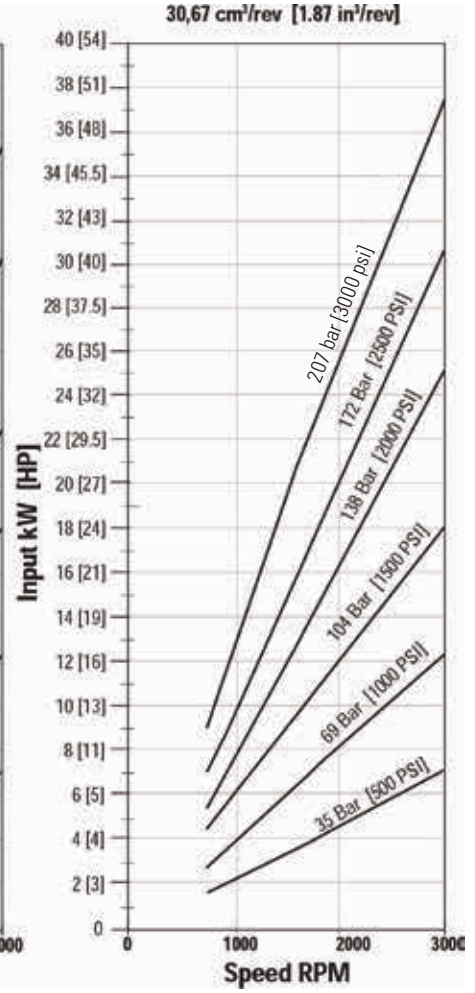
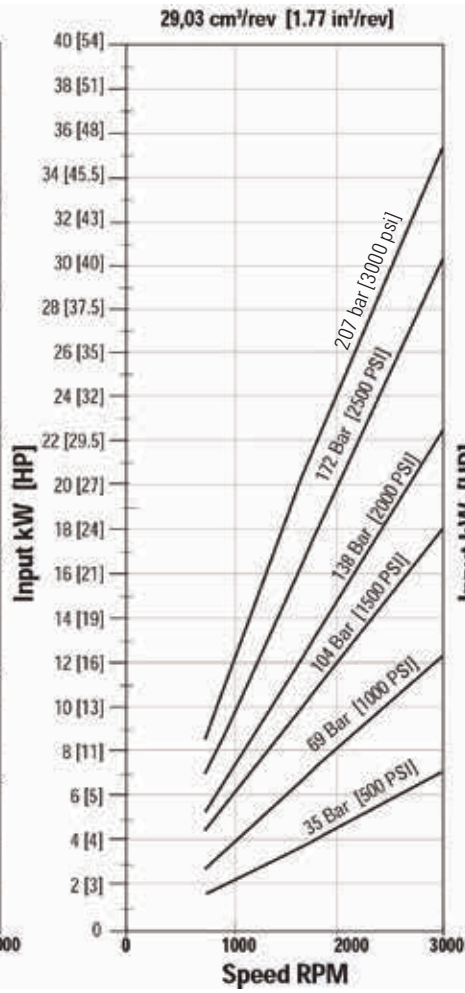
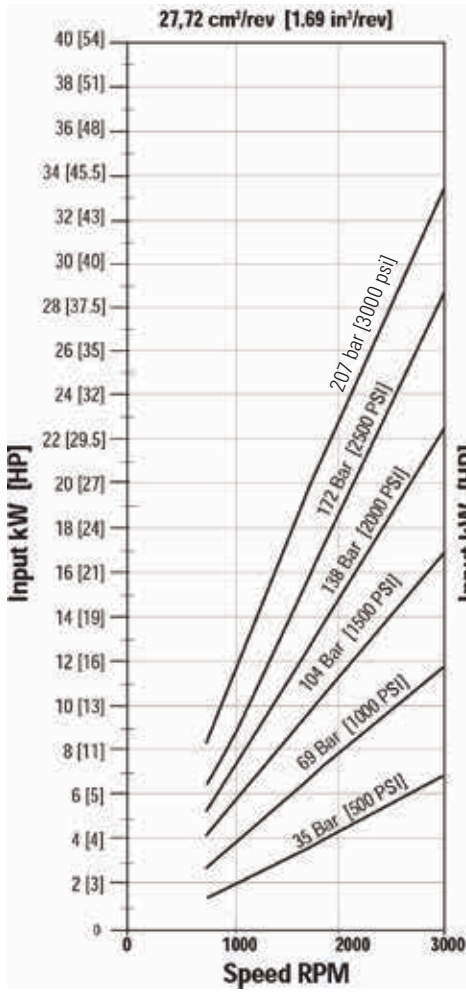

Series 26 pump Standard catalog assemblies - dimensions

***Multiple pump input torque limitations:**

The total torque for multiple pump displacements and pressure combinations cannot exceed the maximum input torque rating of the shaft. The proper formula is pressure times displacement divided by 6.28.

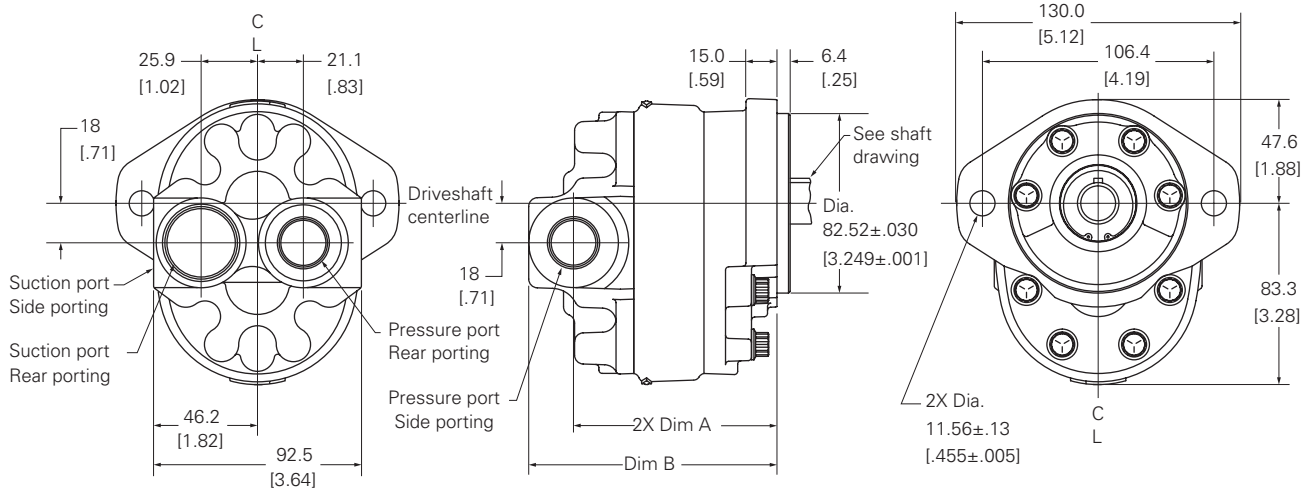

Left hand rotation shown

Model	26001	26002	26003	26004	26005	26006	26007
Displacement (cm ³ /r [in ³ /r])	6.6 [1.40]	8.2 [1.50]	9.5 [1.58]	10.8 [1.66]	13.8 [1.84]	16.7 [1.02]	19.7 [1.20]
Dimension A (mm [in])	72.6 [2.86]	74.3 [2.93]	75.9 [2.99]	77.5 [3.05]	80.7 [3.18]	83.9 [3.30]	87.1 [3.43]
Dimension B (mm [in])	93.2 [3.67]	94.9 [3.74]	96.5 [3.80]	98.1 [3.86]	101.3 [3.99]	104.5 [4.11]	107.7 [4.24]

Model	26008	26009	26010	26011	26012	26013
Displacement (cm ³ /r [in ³ /r])	22.5 [1.37]	24.3 [1.48]	25.2 [1.54]	27.7 [1.69]	29.0 [1.77]	30.6 [1.87]
Dimension A (mm [in])	90.3 [3.56]	92.7 [3.65]	93.5 [3.68]	96.7 [3.81]	98.6 [3.88]	99.9 [3.93]
Dimension B (mm [in])	110.9 [4.37]	113.3 [4.46]	114.1 [4.49]	117.3 [4.62]	119.1 [4.69]	120.5 [4.74]

5/8 Inch 9 tooth spline
maximum input torque 62
nm [550 lb-in]

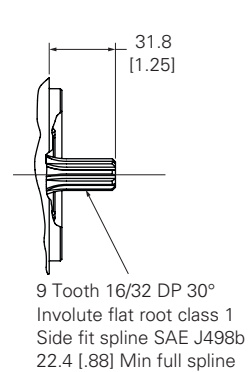

3/4 Inch 11 tooth spline
maximum input torque 119
nm [1050 lb-in]

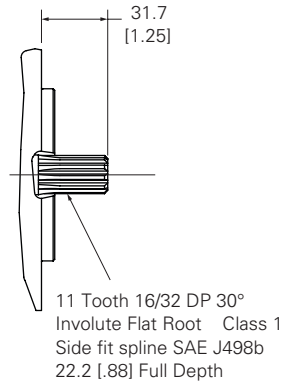

3/4 Inch straight key
maximum input torque 113
nm [1000 lb-in]

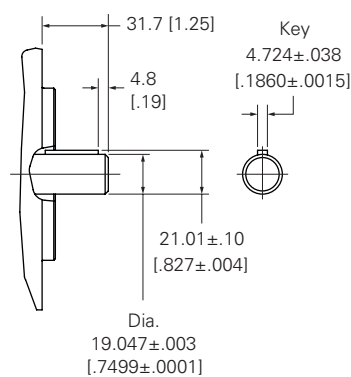

5/8 Inch straight key
maximum input torque 56
nm [500 lb-in]

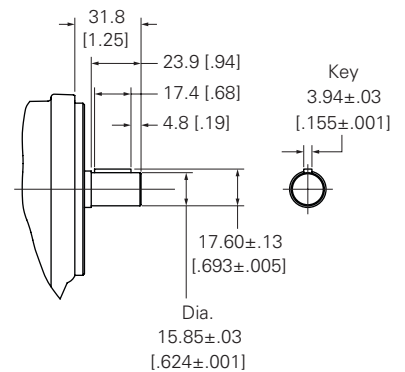

All dimensions are in mm

Series 26 pump Order numbers

Right hand rotation product no	Left hand rotation product no	Shaft	Port location	SAE O-ring pressure port size	SAE O-ring suction port size	Replaces
Model 26001 – 6,6 cm³/r [40 in³/r] displacement						
26001-RZG	26001-LZG	5/8 Keyed	Side	7/8-14 UNF-2B	1-1/16-12 UN-2B	24300-RZA/LZA
26001-RZH	26001-LZH	5/8 Keyed	Rear	7/8-14 UNF-2B	1-1/16-12 UN-2B	24300-RZC/LZD
26001-RZJ	26001-LZJ	5/8 9 T Spline	Side	7/8-14 UNF-2B	1-1/16-12 UN-2B	24300-RZB/LZA
26001-RZK	26001-LZK	5/8 9 T Spline	Rear	7/8-14 UNF-2B	1-1/16-12 UN-2B	24300-RZD/LZE
Model 26002 – 8,2 cm³/r [50 in³/r] displacement						
26002-RZA	26002-LZA	3/4 11T Spline	Side	7/8-14 UNF-2B	1-5/16-12 UN-2B	1-5/16-12 UN-2B
26002-RZB	26002-LZB	3/4 11T Spline	Rear	7/8-14 UNF-2B	1-5/16-12 UN-2B	1-5/16-12 UN-2B
26002-RZC	26002-LZC	3/4 Keyed	Side	7/8-14 UNF-2B	1-5/16-12 UN-2B	1-5/16-12 UN-2B
26002-RZD	26002-LZD	3/4 Keyed	Rear	7/8-14 UNF-2B	1-5/16-12 UN-2B	1-5/16-12 UN-2B
26002-RZE	26002-LZE	5/8 9 T Spline	Side	7/8-14 UNF-2B	1-5/16-12 UN-2B	1-5/16-12 UN-2B
26002-RZF	26002-LZF	5/8 9 T Spline	Rear	7/8-14 UNF-2B	1-5/16-12 UN-2B	1-5/16-12 UN-2B
26002-RZG	26002-LZG	5/8 Keyed	Side	7/8-14 UNF-2B	1-1/16-12 UN-2B	1-1/16-12 UN-2B
26002-RZH	26002-LZH	5/8 Keyed	Rear	7/8-14 UNF-2B	1-1/16-12 UN-2B	1-1/16-12 UN-2B
26002-RZJ	26002-LZJ	5/8 9 T Spline	Side	7/8-14 UNF-2B	1-1/16-12 UN-2B	1-1/16-12 UN-2B
26002-RZK	26002-LZK	5/8 9 T Spline	Rear	7/8-14 UNF-2B	1-1/16-12 UN-2B	1-1/16-12 UN-2B
Model 26003 – 9,5 cm³/r [58 in³/r] displacement						
26003-RZG	26003-LZG	5/8 Keyed	Side	7/8-14 UNF-2B	1-1/16-12 UN-2B	24302-RZB/LZB
26003-RZH	26003-LZH	5/8 Keyed	Rear	7/8-14 UNF-2B	1-1/16-12 UN-2B	24302-RZC/LZD
26003-RZJ	26003-LZJ	5/8 9 T Spline	Side	7/8-14 UNF-2B	1-1/16-12 UN-2B	24302-RZA/LZA
26003-RZK	26003-LZK	5/8 9 T Spline	Rear	7/8-14 UNF-2B	1-1/16-12 UN-2B	24302-RZD/LZE
Model 26004 – 10,8 cm³/r [66 in³/r] displacement						
26004-RZA	26004-LZA	3/4 11T Spline	Side	7/8-14 UNF-2B	1-5/16-12 UN-2B	25301-RSA/LSA
26004-RZB	26004-LZB	3/4 11T Spline	Rear	7/8-14 UNF-2B	1-5/16-12 UN-2B	25301-RSB/LSB
26004-RZC	26004-LZC	3/4 Keyed	Side	7/8-14 UNF-2B	1-5/16-12 UN-2B	25301-RSC/LSC
26004-RZD	26004-LZD	3/4 Keyed	Rear	7/8-14 UNF-2B	1-5/16-12 UN-2B	25301-RSD/LSD
26004-RZE	26004-LZE	5/8 9 T Spline	Side	7/8-14 UNF-2B	1-5/16-12 UN-2B	25301-RSE/LSE
26004-RZF	26004-LZF	5/8 9 T Spline	Rear	7/8-14 UNF-2B	1-5/16-12 UN-2B	25301-RSF/LSF
26004-RZG	26004-LZG	5/8 Keyed	Side	7/8-14 UNF-2B	1-1/16-12 UN-2B	24303-RZB/LZB
26004-RZH	26004-LZH	5/8 Keyed	Rear	7/8-14 UNF-2B	1-1/16-12 UN-2B	24303-RZE/LZF
26004-RZJ	26004-LZJ	5/8 9 T Spline	Side	7/8-14 UNF-2B	1-1/16-12 UN-2B	24303-RZD/LZA
26004-RZK	26004-LZK	5/8 9 T Spline	Rear	7/8-14 UNF-2B	1-1/16-12 UN-2B	24303-RZF/LZG
Model 26005 – 13,8 cm³/r [84 in³/r] displacement						
26005-RZA	26005-LZA	3/4 11T Spline	Side	7/8-14 UNF-2B	1-5/16-12 UN-2B	25302-RSA/LSA
26005-RZB	26005-LZB	3/4 11T Spline	Rear	7/8-14 UNF-2B	1-5/16-12 UN-2B	25302-RSB/LSB
26005-RZC	26005-LZC	3/4 Keyed	Side	7/8-14 UNF-2B	1-5/16-12 UN-2B	25302-RSC/LSC
26005-RZD	26005-LZD	3/4 Keyed	Rear	7/8-14 UNF-2B	1-5/16-12 UN-2B	25302-RSD/LSD
26005-RZE	26005-LZE	5/8 9 T Spline	Side	7/8-14 UNF-2B	1-5/16-12 UN-2B	25302-RSE/LSE
26005-RZF	26005-LZF	5/8 9 T Spline	Rear	7/8-14 UNF-2B	1-5/16-12 UN-2B	25302-RSF/LSF
26005-RZG	26005-LZG	5/8 Keyed	Side	7/8-14 UNF-2B	1-1/16-12 UN-2B	24304-RZC/LZA
26005-RZH	26005-LZH	5/8 Keyed	Rear	7/8-14 UNF-2B	1-1/16-12 UN-2B	24304-RZG/LZF
26005-RZJ	26005-LZJ	5/8 9 T Spline	Side	7/8-14 UNF-2B	1-1/16-12 UN-2B	24304-RZD/LZB
26005-RZK	26005-LZK	5/8 9 T Spline	Rear	7/8-14 UNF-2B	1-1/16-12 UN-2B	24304-RZH/LZG

* 5/8 9 T Spline has a maximum allowable input torque of 62 Nm [550 lb-in].

** 5/8 Keyed shaft has a maximum allowable input torque of 56 Nm [500 lb-in].

Series 26 pump Order numbers

Right hand rotation product no	Left hand rotation product no	Shaft	Port location	SAE O-ring pressure port size	SAE O-ring suction port size	Replaces
Model 26006 – 16,7 cm³/r [1.02 in³/r] displacement						
26006-RZA	26006-LZA	3/4 11T Spline	Side	7/8-14 UNF-2B	1-5/16-12 UN-2B	25303-RSA/LSA
26006-RZB	26006-LZB	3/4 11T Spline	Rear	7/8-14 UNF-2B	1-5/16-12 UN-2B	25303-RSB/LSB
26006-RZC	26006-LZC	3/4 Keyed	Side	7/8-14 UNF-2B	1-5/16-12 UN-2B	25303-RSC/LSC
26006-RZD	26006-LZD	3/4 Keyed	Rear	7/8-14 UNF-2B	1-5/16-12 UN-2B	25303-RSD/LSD
26006-RZE	26006-LZE	5/8 9 T Spline	Side	7/8-14 UNF-2B	1-5/16-12 UN-2B	25303-RSE/LSE
26006-RZF	26006-LZF	5/8 9 T Spline	Rear	7/8-14 UNF-2B	1-5/16-12 UN-2B	25303-RSF/LSF
26006-RZG	26006-LZG	5/8 Keyed	Side	7/8-14 UNF-2B	1-1/16-12 UN-2B	24305-RZC/LZA
26006-RZH	26006-LZH	5/8 Keyed	Rear	7/8-14 UNF-2B	1-1/16-12 UN-2B	24305-RZG/LZF
26006-RZJ	26006-LZJ	5/8 9 T Spline	Side	7/8-14 UNF-2B	1-1/16-12 UN-2B	24305-RZD/LZB
26006-RZK	26006-LZK	5/8 9 T Spline	Rear	7/8-14 UNF-2B	1-1/16-12 UN-2B	24305-RZH/LZG
Model 26007 – 19,7 cm³/r [1.20 in³/r] Displacement						
26007-RZA	26007-LZA	3/4 11T Spline	Side	7/8-14 UNF-2B	1-5/16-12 UN-2B	25304-RSA/LSA
26007-RZB	26007-LZB	3/4 11T Spline	Rear	7/8-14 UNF-2B	1-5/16-12 UN-2B	25304-RSB/LSB
26007-RZC	26007-LZC	3/4 Keyed	Side	7/8-14 UNF-2B	1-5/16-12 UN-2B	25304-RSC/LSC
26007-RZD	26007-LZD	3/4 Keyed	Rear	7/8-14 UNF-2B	1-5/16-12 UN-2B	25304-RSD/LSD
26007-RZE	26007-LZE	*5/8 9 T Spline	Side	7/8-14 UNF-2B	1-5/16-12 UN-2B	25304-RSE/LSE
26007-RZF	26007-LZF	*5/8 9 T Spline	Rear	7/8-14 UNF-2B	1-5/16-12 UN-2B	25304-RSF/LSF
26007-RZG	26007-LZG	**5/8 Keyed	Side	7/8-14 UNF-2B	1-1/16-12 UN-2B	24306-RZA/LZA
26007-RZH	26007-LZH	**5/8 Keyed	Rear	7/8-14 UNF-2B	1-1/16-12 UN-2B	24306-RZE/LZF
26007-RZJ	26007-LZJ	*5/8 9 T Spline	Side	7/8-14 UNF-2B	1-1/16-12 UN-2B	24306-RZD/LZB
26007-RZK	26007-LZK	*5/8 9 T Spline	Rear	7/8-14 UNF-2B	1-1/16-12 UN-2B	24306-RZF/LZG
Model 26008 – 22,5 cm³/r [1.37 in³/r] Displacement						
26008-RZA	26008-LZA	3/4 11T Spline	Side	7/8-14 UNF-2B	1-5/16-12 UN-2B	25305-RSA/LSA
26008-RZB	26008-LZB	3/4 11T Spline	Rear	7/8-14 UNF-2B	1-5/16-12 UN-2B	25305-RSB/LSB
26008-RZC	26008-LZC	3/4 Keyed	Side	7/8-14 UNF-2B	1-5/16-12 UN-2B	25305-RSC/LSC
26008-RZD	26008-LZD	3/4 Keyed	Rear	7/8-14 UNF-2B	1-5/16-12 UN-2B	25305-RSD/LSD
26008-RZE	26008-LZE	*5/8 9 T Spline	Side	7/8-14 UNF-2B	1-5/16-12 UN-2B	25305-RSE/LSE
26008-RZF	26008-LZF	*5/8 9 T Spline	Rear	7/8-14 UNF-2B	1-5/16-12 UN-2B	25305-RSF/LSF
Model 26009 – 24,3 cm³/r [1.48 in³/r] Displacement						
26009-RZG	26009-LZG	**5/8 Keyed	Side	7/8-14 UNF-2B	1-1/16-12 UN-2B	24307-RZC/LZA
26009-RZH	26009-LZH	**5/8 Keyed	Rear	7/8-14 UNF-2B	1-1/16-12 UN-2B	24307-RZG/LZF
26009-RZJ	26009-LZJ	*5/8 9 T Spline	Side	7/8-14 UNF-2B	1-1/16-12 UN-2B	24307-RZD/LZB
26009-RZK	26009-LZK	*5/8 9 T Spline	Rear	7/8-14 UNF-2B	1-1/16-12 UN-2B	24307-RZH/LZG
Model 26010 – 25,2 cm³/r [1.54 in³/r] Displacement						
26010-RZA	26010-LZA	3/4 11T Spline	Side	7/8-14 UNF-2B	1-5/16-12 UN-2B	25306-RSA/LSA
26010-RZB	26010-LZB	3/4 11T Spline	Rear	7/8-14 UNF-2B	1-5/16-12 UN-2B	25306-RSB/LSB
26010-RZC	26010-LZC	3/4 Keyed	Side	7/8-14 UNF-2B	1-5/16-12 UN-2B	25306-RSC/LSC
26010-RZD	26010-LZD	3/4 Keyed	Rear	7/8-14 UNF-2B	1-5/16-12 UN-2B	25306-RSD/LSD
26010-RZE	26010-LZE	*5/8 9 T Spline	Side	7/8-14 UNF-2B	1-5/16-12 UN-2B	25306-RSE/LSE
26010-RZF	26010-LZF	*5/8 9 T Spline	Rear	7/8-14 UNF-2B	1-5/16-12 UN-2B	25306-RSF/LSF

* 5/8 9 T Spline has a maximum allowable input torque of 62 Nm [550 lb-in].

** 5/8 Keyed shaft has a maximum allowable input torque of 56 Nm [500 lb-in].

Series 26 pump Order numbers

Right hand rotation product no	Left hand rotation product no	Shaft	Port location	SAE O-ring pressure port size	SAE O-ring suction port size	Replaces
Model 26011 – 27,7 cm³/r [1.69 in³/r] Displacement						
26011-RZA	26011-LZA	3/4 11T Spline	Side	7/8-14 UNF-2B	1-5/16-12 UN-2B	25307-RSA/LSA
26011-RZB	26011-LZB	3/4 11T Spline	Rear	7/8-14 UNF-2B	1-5/16-12 UN-2B	25307-RSB/LSB
26011-RZC	26011-LZC	3/4 Keyed	Side	7/8-14 UNF-2B	1-5/16-12 UN-2B	25307-RSC/LSC
26011-RZD	26011-LZD	3/4 Keyed	Rear	7/8-14 UNF-2B	1-5/16-12 UN-2B	25307-RSD/LSD
26011-RZE	26011-LZE	*5/8 9 T Spline	Side	7/8-14 UNF-2B	1-5/16-12 UN-2B	25307-RSE/LSE
26011-RZF	26011-LZF	*5/8 9 T Spline	Rear	7/8-14 UNF-2B	1-5/16-12 UN-2B	25307-RSF/LSF
Model 26012 – 29,0 cm³/r [1.77 in³/r] Displacement						
26012-RZG	26012-LZG	**5/8 Keyed	Side	7/8-14 UNF-2B	1-1/16-12 UN-2B	24308-RZA/LZA
26012-RZH	26012-LZH	**5/8 Keyed	Rear	7/8-14 UNF-2B	1-1/16-12 UN-2B	24308-RZE/LZF
26012-RZJ	26012-LZJ	*5/8 9 T Spline	Side	7/8-14 UNF-2B	1-1/16-12 UN-2B	24308-RZD/LZB
26012-RZK	26012-LZK	*5/8 9 T Spline	Rear	7/8-14 UNF-2B	1-1/16-12 UN-2B	24308-RZF/LZG
Model 26013 – 30,6 cm³/r [1.87 in³/r] Displacement						
26013-RZA	26013-LZA	3/4 11T Spline	Side	7/8-14 UNF-2B	1-5/16-12 UN-2B	25308-RZA/LZA
26013-RZB	26013-LZB	3/4 11T Spline	Rear	7/8-14 UNF-2B	1-5/16-12 UN-2B	25308-RZB/LZB
26013-RZC	26013-LZC	3/4 Keyed	Side	7/8-14 UNF-2B	1-5/16-12 UN-2B	25308-RZC/LZC
26013-RZD	26013-LZD	3/4 Keyed	Rear	7/8-14 UNF-2B	1-5/16-12 UN-2B	25308-RZD/LZD
26013-RZE	26013-LZE	*5/8 9 T Spline	Side	7/8-14 UNF-2B	1-5/16-12 UN-2B	25308-RZE/LZE
26013-RZF	26013-LZF	*5/8 9 T Spline	Rear	7/8-14 UNF-2B	1-5/16-12 UN-2B	25308-RZF/LZF

* 5/8 9 T Spline has a maximum allowable input torque of 62 Nm [550 lb-in].

** 5/8 Keyed shaft has a maximum allowable input torque of 56 Nm [500 lb-in].

Series 26 pump Optional configurations

The series 26 gear pump components can be assembled into many optional configurations. The versatile design allows you to assemble a pump to meet your specific needs.

Model codes for single and multiple pumps along with the component part dimension drawings are given on the following pages.

Single gear pump with tandem backplate

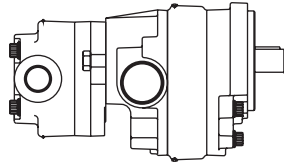

Double gear pump with tandem backplate

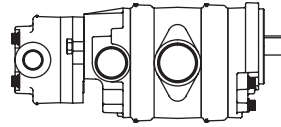

Triple gear pump with two suction ports and tandem backplate

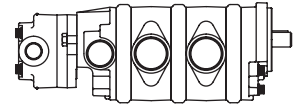

Single gear pump

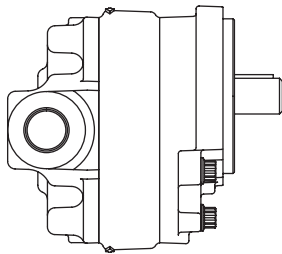

Double gear pump with common suction port

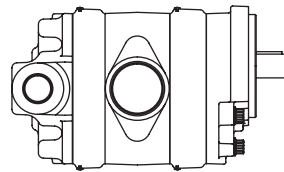

Single gear pump w/
tandem flow divider
backplate

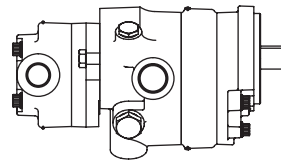

Double gear pump with
tandem flow divider
backplate

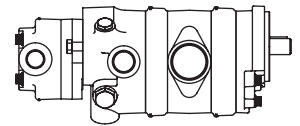

Triple gear pump with two
suction ports

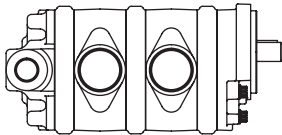

Triple gear pump with two
suction ports and tandem
flow divider backplate

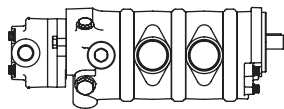

Single gear pump with
relief valve

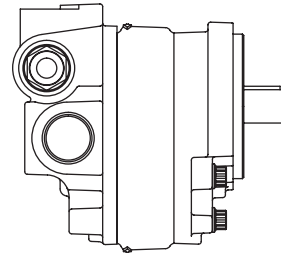

Double gear pump with
relief valve

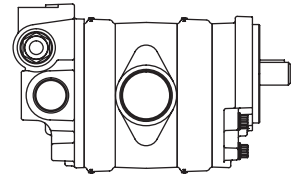

Single gear pump with flow
divider and relief valve

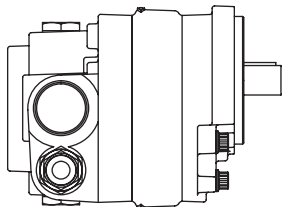

Double gear pump with
flow divider and relief valve

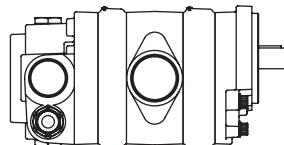

Triple gear pump with two
suction ports and relief
valve

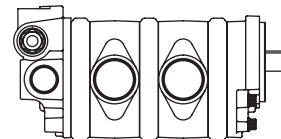

Triple gear pump with two
suction ports, flow divider
and relief valve

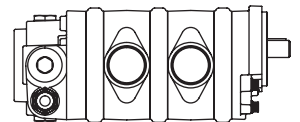

Series 26 pump

Component parts - dimensions

Front plate

SAE A 2 bolt flange used on all standard catalog assemblies

"B" Mount

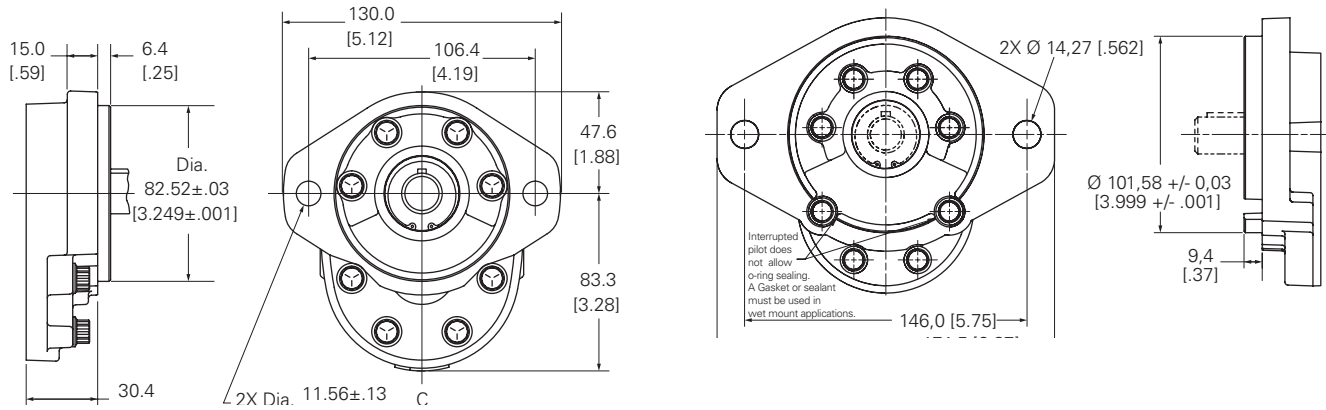

4 Bolt euro mount

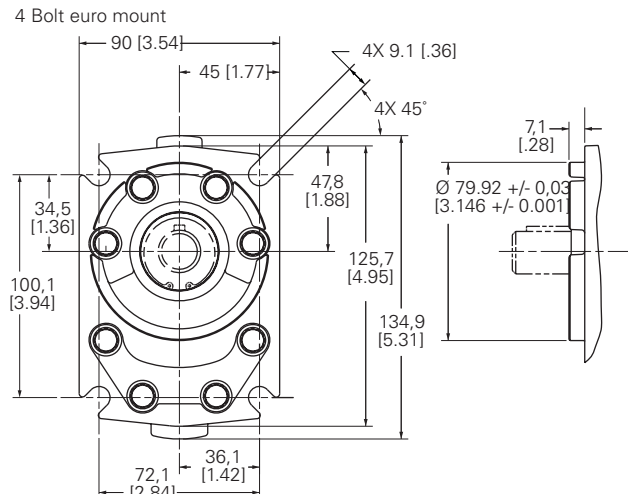

Body

Used on single and multiple pumps

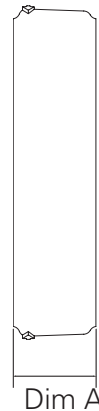

Model	26001	26002	26003	26004	26005	26006	26007
Displacement (cm ³ /r [in ³ /r])	6.6 [.40]	8.2 [.50]	9.5 [.58]	10.8 [.66]	13.8 [.84]	16.7 [1.02]	19.7 [1.20]
Dimension A (mm [in])	14.4 [.57]	16.3 [.64]	17.7 [.70]	19.5 [.77]	22.7 [.89]	25.9 [1.02]	29.1 [1.15]

Model	26008	26009	26010	26011	26012	26013
Displacement (cm ³ /r [in ³ /r])	22.5 [1.37]	24.3 [1.48]	25.2 [1.54]	27.7 [1.69]	29.0 [1.77]	30.6 [1.87]
Dimension A (mm [in])	32.3 [1.27]	34.7 [1.36]	35.5 [1.40]	38.7 [1.52]	40.3 [1.59]	41.9 [1.65]

All dimensions are in mm [in].

Series 26 pump Component parts - dimensions

Backplate

Used on single and multiple pumps

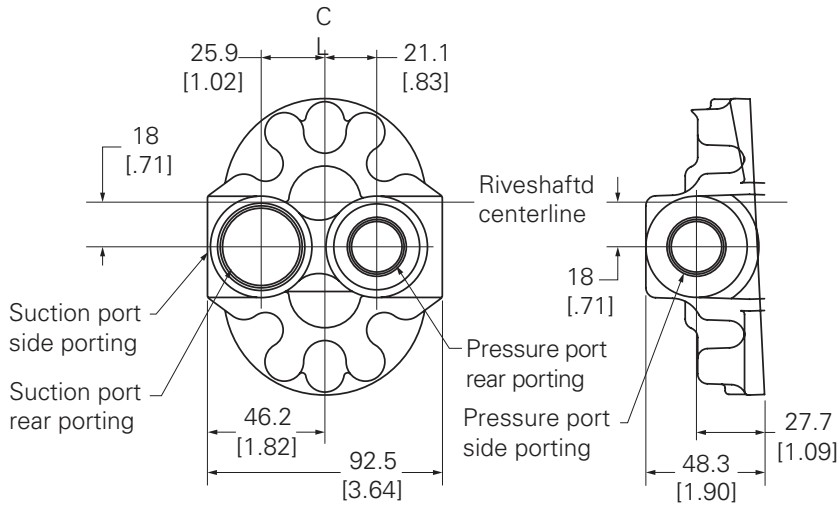

Left hand rotation shown

Flow divider backplate

Used on single and multiple pumps

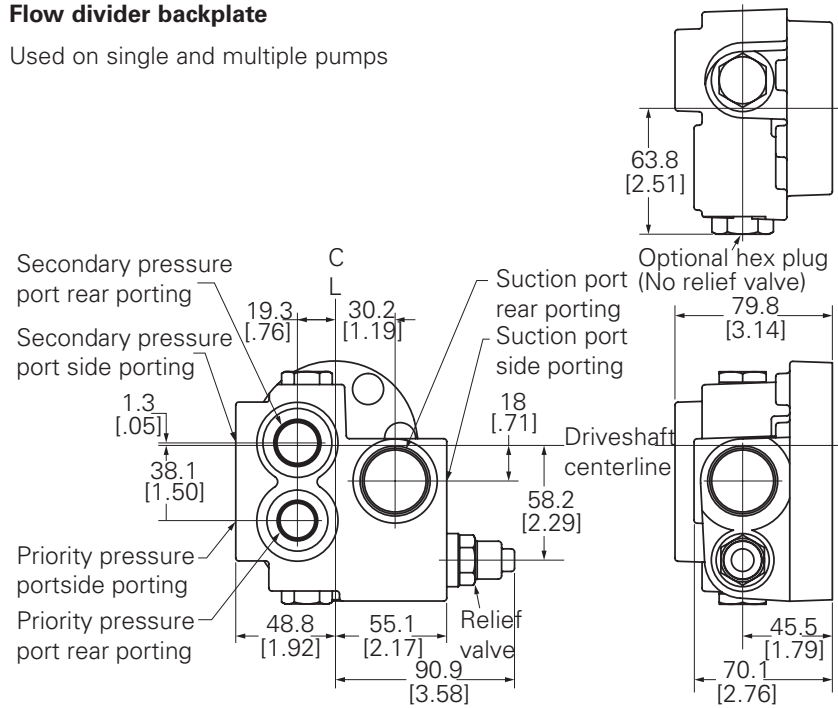

Right hand rotation shown

Right hand rotation shown

All dimensions are in mm [in].

Series 26 pump Component parts - dimensions

Relief valve backplate

Used on single and multiple pumps - right hand rotation shown

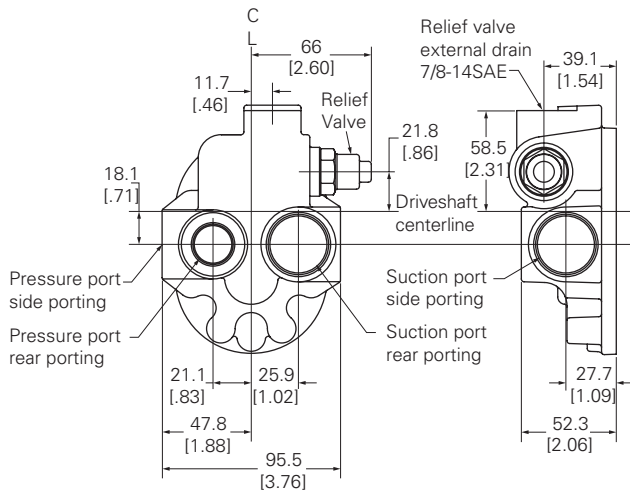

Adaptor plate

Used on multiple pumps - right hand rotation shown

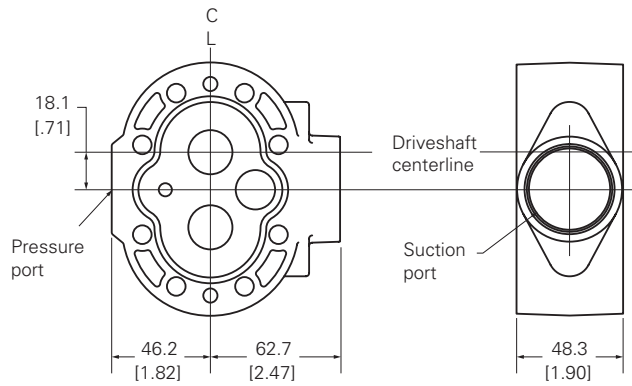

Tandem backplate

Used on single and multiple pumps SAE AA 2 bolt flange

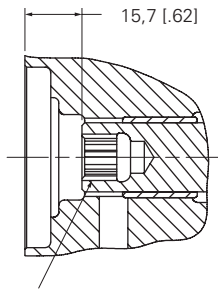

9 tooth 20/40 DP 30°
invlt flat rootclass I
side fit spline SAE J498b
9,7 [0.38] min. full spline

Max torque rating: 29.5 Nm [261 lbf•

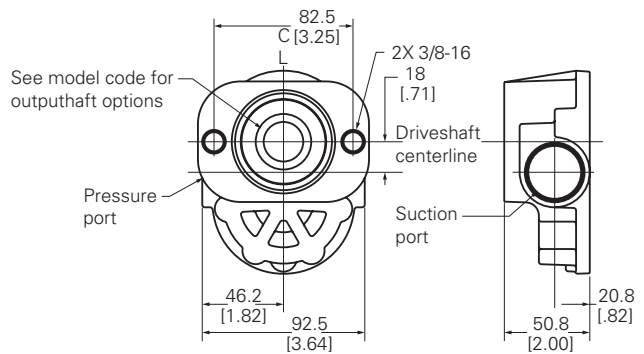

Right hand rotation shown

All dimensions are in mm [in].

Series 26 pump Model code single

Series 26 gear pumps can be ordered by using the following model code.

A twenty-four digit coding system has been designed to identify the features presently available on single gear pumps. The characters and their relative positions within the code identify specific features.

Use the model code matrix as an aid when assembling the model code for the pump with the features you desire. It may be helpful to photocopy the matrix and write the numbers and letters into the boxes as you select features.

All twenty-four digits of the code must be submitted when ordering.

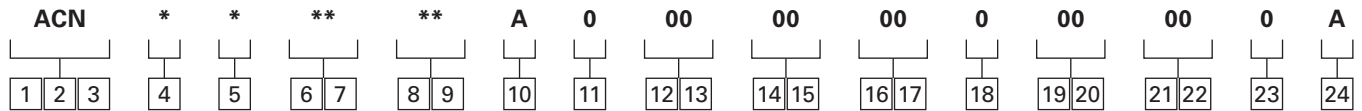

1	2	3	26 Series	ACN	Gear pump - single unit
4	Unit type				
	A	Plain			
	B	Flow divider with/without relief valve (pos. 14-15)			
	C	Relief valve (pos. 16-17)			
5	Input rotation (viewed from input shaft end)				
	L	Left-hand rotation CCW			
	R	Right-hand rotation CW			
6	7	Displacement (cm³/r [in³/r])			
	01	6.6 [.40]			
	02	8.2 [.50]			
	03	9.5 [.58]			
	04	10.8 [.66]			
	05	13.8 [.84]			
	06	16.7 [1.02]			
	07	19.7 [1.20]			
	08	22.5 [1.37]			
	09	24.3 [1.48]			
	10	25.2 [1.54]			
	11	27.7 [1.69]			
	12	29.0 [1.77]			
	13	30.6 [1.87]			
8	9	Input shaft			
	AA	5/8 Inch dia. 9 Tooth spline 16/32 pitch shaft extension 31.8 [1.25]			
	AB	3/4 Inch dia. 11 Tooth spline 16/32 pitch shaft extension 31.8 [1.25]			
	AC	3/4 Inch dia. Straight keyed, keyway 4.8 X 25.4 [.19 X 1.00] Shaft extension 31.8 [1.25]			
	AD	5/8 Inch dia. Straight keyed, keyway 4.1 X 18.3 [.16 X .72] Shaft extension 31.8 [1.25]			

10	Mounting features				
	A	SAE 2-bolt a flange, series 82-2			
	B	SAE 2-bolt A flange with thru drain			
	C	SAE 2-bolt b flange, series 101-2			
	D	European 4-bolt			
11	Auxiliary mounting features				
	0	No rear mounting			
	C	(2-Bolt AA) SAE flange series 50-2, with 9 tooth internal spline 20/40 pitch, accepts 25.4 [1.00] Shaft extension			
12	13	Ports, sizes and location- backplate			
	01	Plain: suction port 1.3125-12 UN-2B SAE O-ring port; pressure port .875-14 UNF-2B SAE O-ring port - side sports			
	02	Plain: suction port 1.3125-12 UN-2B SAE O-ring port; pressure port .875-14 UNF-2B SAE O-ring port - rear ports			
	03	Plain: suction port 1.0625-12 UN-2B SAE O-ring port; pressure port .875-14 UNF-2B SAE O-ring port accepts fittings per SAE J1926 - side ports			
	04	Plain: suction port 1.0625-12 UN-2B SAE O-ring port; pressure port .875-14 UNF-2B SAE O-ring port accepts fittings per SAE J1926 -rear ports			
	08	Plain thru shaft: suction port 1.0625-12 UN-2B SAE Oring port; pressure port .875-14 UNF-2B SAE O-ring port - side ports			
	15	Relief valve: suction port 1.0625-12 UN-2B SAE O-ring port; pressure port .875-14 UNF-2B SAE O-ring port - side ports; drain port .875-14 UNF- 2B SAE O-ring port			
	16	Relief valve: suction port 1.0625-12 UN-2B SAE O-ring port; pressure port .875-14 UNF-2B SAE O-ring port - rear ports; drain port .875-14 UNF- 2B SAE O-ring port			
	20	Flow divider: suction port 1.3125-12 UN-2B SAE O-ring port; priority pressure port .750-16 UNF-2B SAE Oring port; secondary pressure port .875-14 UNF-2B SAE Oring Port - Side Ports			

All dimensions are in inches.

Series 26 pump

Model code single

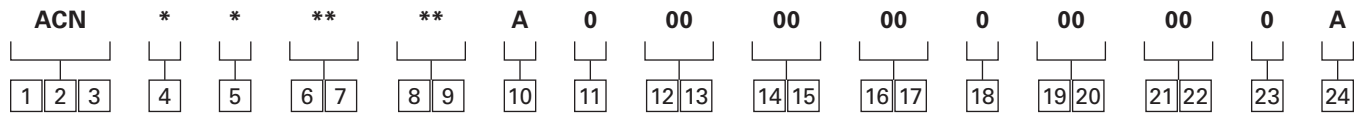

21 Flow Divider: Suction Port 1.3125-12 UN-2B SAE O-ring Port; Priority Pressure Port .750-16 UNF-2B SAE Oring Port; Secondary Pressure Port .875-14 UNF-2B SAE Oring Port - Rear Ports

14 15 **Priority flow divider setting (LPM [GPM])**

00 No Flow Setting
AA 3.8 [1.00]
AD 7.6 [2.00]
AJ 11.4 [3.00]
AL 15.1 [4.00]
AN 18.9 [5.00]
AR 22.7 [6.00]
AS 26.5 [7.00]
AT 30.3 [8.00]

16 17 **Relief valve full flow setting (bar [PSI])**

00 No Relief Valve Setting
AA 34.5 [500]
AB 51.7 [750]
AC 68.9 [1000]
AE 86.2 [1250]
AF 103.4 [1500]
AJ 120.7 [1750]
AL 137.9 [2000]
AN 155.1 [2250]
AP 172.4 [2500]
AR 189.6 [2750]
AS 206.8 [3000]
BR 241.3 [3500]
BT 224.1 [3250]

18 **Test Data**

0 Generic
A A - Unit Specific (required for flow divider and relief valve options.)

19 20 **Special features**

00 No Special Features
AB Viton Shaft Seal

21 22 **Paint**

00 None
0A Red Primer
0B Black

23 **Identification**

0 Standard

24 **Design code**

A A

All dimensions are in inches.

Series 26 pump Model code multiple

Series 26 Gear Pumps can be ordered by using the following Model Code.

A thirty-two digit coding system has been designed to identify the features presently available on Multiple gear

pumps. The characters and their relative positions within the code identify specific features. Use the Model Code Matrix as an aid when assembling the model code for the pump with the features you desire. It may be helpful

to photocopy the matrix and write the numbers and letters into the boxes as you select features.

All thirty-two digits of the code must be submitted when ordering.

ACM	*	*	**	**	**	**	**	**	**	00	00	A	0	0	00	00	0	B													
1	2	3	4	5	6	7	8	9	10	11	12	13	14	15	16	17	18	19	20	21	22	23	24	25	26	27	28	29	30	31	32

1	2	3	26 Series
	ACM	Gear Pump - Multiple Unit	
4	Unit type		
	A	Plain	
	B	Flow Divider with/without Relief Valve (Pos. 20-21)	
	C	Relief Valve	
5	Input rotation (viewed from input shaft end)		
	L	Left-hand Rotation CCW	
	R	Right-hand Rotation CW	
6	7	Displacement - front (cm³/r [in³/r])	
	01	6.6 [.40]	
	02	8.2 [.50]	
	03	9.5 [.58]	
	04	10.8 [.66]	
	05	13.8 [.84]	
	06	16.7 [1.02]	
	07	19.7 [1.20]	
	08	22.5 [1.37]	
	09	24.3 [1.48]	
	10	25.2 [1.54]	
	11	27.7 [1.69]	
	12	29.0 [1.77]	
	13	30.6 [1.87]	
8	9	Displacement - Ctr. triple only (cm³/r [in³/r])	
	01	6.6 [.40]	
	02	8.2 [.50]	
	03	9.5 [.58]	
	04	10.8 [.66]	
	05	13.8 [.84]	
	06	16.7 [1.02]	
	07	19.7 [1.20]	
	08	22.5 [1.37]	
	09	24.3 [1.48]	
	10	25.2 [1.54]	
	11	27.7 [1.69]	
	12	29.0 [1.77]	
	13	30.6 [1.87]	
	99	No Center Displacement	

10	11	Displacement - front (cm³/r [in³/r])
	01	6.6 [.40]
	02	8.2 [.50]
	03	9.5 [.58]
	04	10.8 [.66]
	05	13.8 [.84]
	06	16.7 [1.02]
	07	19.7 [1.20]
	08	22.5 [1.37]
	09	24.3 [1.48]
	10	25.2 [1.54]
	11	27.7 [1.69]
	12	29.0 [1.77]
	13	30.6 [1.87]
12	13	Input shaft
	AA	5/8 Inch Dia. 9 Tooth Spline 16/32 Pitch Shaft Extension 31.8 [1.25]
	AB	3/4 Inch Dia. 11 Tooth Spline 16/32 Pitch Shaft Extension 31.8 [1.25]
	AC	3/4 Inch Dia. Straight Keyed, Keyway 4.8 x 25.4 [.19 x 1.00] Shaft Extension 31.8 [1.25]
	AD	5/8 Inch Dia. Straight Keyed, Keyway 4.1 X 18.3 [.16 X .72] Shaft Extension 31.8 [1.25]
14	15	Front adapter ports
	01	Suction Port 1-5/8-12 UN-2B SAE O-ring Port; Pressure Port 7/8-14 UNF-2B SAE O-ring Port
	05	Suction Port 1-5/16-12 UN-2B SAE O-ring Port; Pressure Port 7/8-14 UNF-2B SAE O-ring Port
16	17	Ports - rear adapter (triple units)
	00	No Rear Adaptor
	01	Suction Port 1-5/8-12 UN-2B SAE O-ring Port; Pressure Port 7/8-14 UNF-2B SAE O-ring Port
	05	05 = Suction Port 1-5/16-12 UN-2B SAE O-ring Port; Pressure Port 7/8-14 UNF-2B SAE O-ring Port

All dimensions are in inches.